

# GH833 OEM Kit

311492B

- Use with Architectural Coating, Paints, Roof Coatings and Below Grade Coatings -

## Part No. 249767, 253473

4000 psi (27.6 MPa, 275.8 bar) Maximum Working Pressure (Material Working PSI)



### Important Safety Instructions

Read all warnings and instructions in this manual.  
Save these instructions.

## Technical Data

Paint/Hydraulic Ratio	1.45:1
User Supplied Input	
• Max Hydraulic Pressure	2750 psi (190 bar, 19.0 MPa)
• Hydraulic Flow Required	6.25 gpm (23.6 lpm)
Unit Output	
• Max Fluid Pressure	4000 psi (275 bar, 27.6 MPa)
• Max Flow	4 gpm (15.1 lpm)
Max Cycle Rate	64 cpm
Dimensions	
Height	39.5 in. (1003 mm)
Width	7.5 in. (190.5 mm)
Depth	5.5 in. (140 mm)
Weight	63 lbs (28.6 kg)

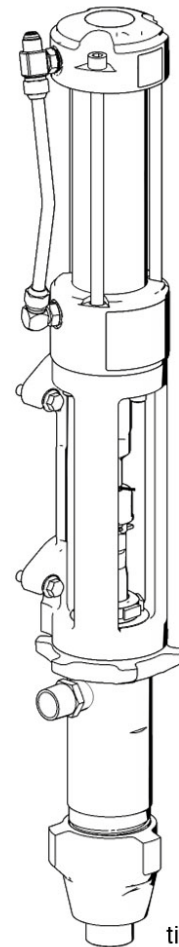

ti7580a

PROVEN QUALITY. LEADING TECHNOLOGY.

# Parts

FN	Part No.	Description	Qty	FN	Part No.	Description	Qty
				105	117607	FITTING, elbow std thd	1
7	120226	SCREW, hex hd, flange	4	106	117609	FITTING, tee, branch, str thd	1
36	287834	KIT, pump, displacement, includes 141	1	121	116407	CLIP, hairpin	1
40	116554	WASHER, flat	1	122	15G204	NUT, retaining	1
42	15G501	SLEEVE, valve, hydr, motor	1	124	197340	COVER, coupler	1
43	15G503	STOP, valve, hydraulic motor	1	125	244819	COUPLING, assembly	1
44	15D256	SCREW, cap, sch	2	141	15H335	FITTING, nipple, 1 in. npt, includes 36	1
45	101947	BALL, bearing	2	169▲	15G877	LABEL, front	1
46	15G270	YOKE, arm, hydraulic motor	2	170	15G878	LABEL, Graco logo	1
48	105270	SCREW, shoulder, sch	4	175▲	15B063	LABEL, includes 75	1
52	287869	CYLINDER, hydraulic motor	1	163‡†	15H201	SHIELD, pump	1
53	287870	KIT, repair, packing, hydraulic, includes 62	1	164‡	111235	SCREW, mach, pnh	1
53a		BEARING, piston	1	165‡	120317	NUT, wing	1
53b		O-RING, piston	1	▲ Replacement Danger and Warning labels, tags, and cards are available at no cost.			
53c		SEAL, piston, hydraulic motor	1	‡ Use on model 253473.			
53d		SEAL, rod	1	<b>Item Description</b>			
53e		BEARING, rod	1	△	HYDRAULIC INLET, 3/4 in. - 16 UNF 2A, 37° flared male		
5ef		WIPER, rod	1	△	HYDRAULIC RETURN, 1-1/6 in. - 12 UN 2A, 37° flared male		
62	116084	PACKING, o-ring	2	△	MOUNTING SLOT, 4X, 7/16 in. - 14 UNC 2B, flange head, cap screw, 1-3/4 in. long recommended (Graco PN 120226)		
63	15G559	HOUSING, hydraulic motor, lower	1	△	1 in. - 11-1/2 NPT Female		
66	101970	PLUG, pipe	1	△	1-1/2 in. - 11-1/2 NPT Male		
73	15G639	ADAPTER, hydraulic motor/pump	1				
74	120202	SCREW, cap sch	3				
75	288061	CAP, hydraulic head, includes 175	1				
76	287868	PISTON, hydraulic	1				
90	120138	SCREW, cap, socket head	3				
91	120146	SPRING, compression	1				
97	287841	TUBE	1				
104	120065	FITTING, hydraulic	1				

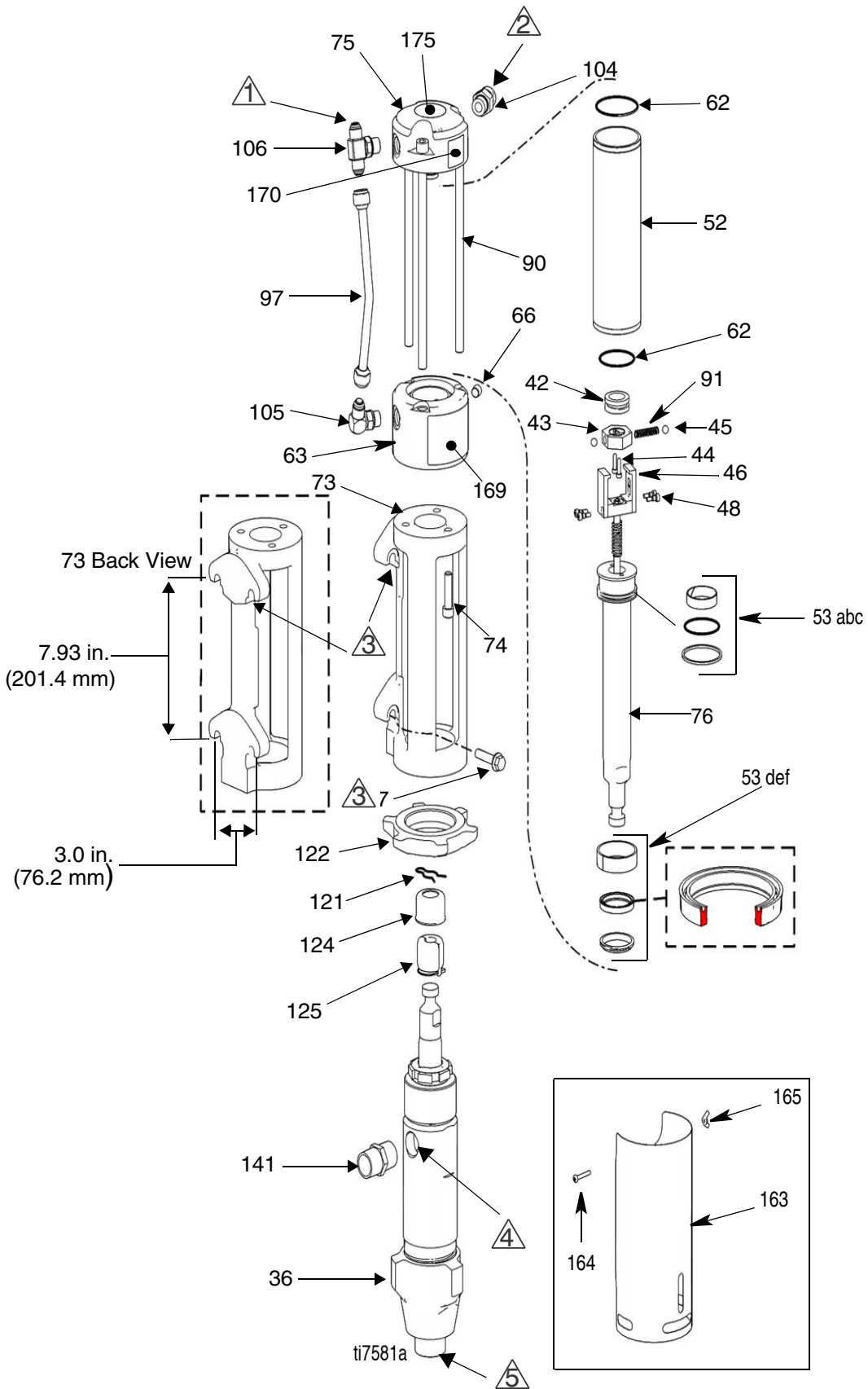

*All written and visual data contained in this document reflects the latest product information available at the time of publication.  
Graco reserves the right to make changes at any time without notice.*

**Graco Headquarters:** Minneapolis

**International Offices:** Belgium, China, Japan, Korea

**GRACO INC. P.O. BOX 1441 MINNEAPOLIS, MN 55440-1441**

[www.graco.com](http://www.graco.com)

4/2006, Revised: 6/2006